

# MKD SERIES COLLET TYPE PERMANENT - MAGNET SYNCHRONOUS COUPLING

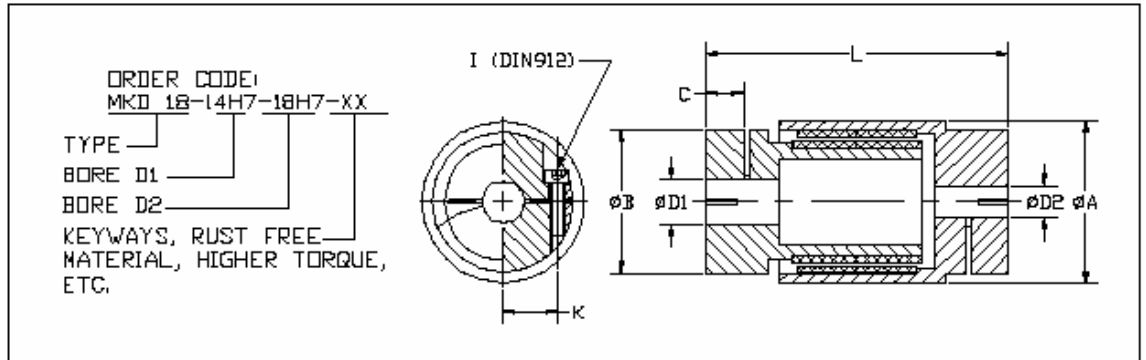

## DIMENSIONS: (mm)

Type MKD	ØA	ØB	C	ØD1 and ØD2		K	L	M Magnet Length (mm)
				Min - Max	I			
					DIN 912			
MKD 2	31	24	8.2	3 - 10	M3	9	55	20
MKD 4	38	32	10	6 - 16	M4	11.5	58	20
MKD 10	46	40	10	6 - 19	M4	15.5	57	20
MKD 18	51	45	12	10 - 26	M5	17.5	78	30

## TECHNICAL DATA:

Type MKD	Moment of Inertia		Overload Torque (Nm) <sup>6)</sup>	Mass		Torque to Tighten Clamps (Nm)	Misalignment Lateral (mm)
	Inside (10 <sup>-3</sup> kgm <sup>2</sup> )	Outside		Inside	Outside		
MKD 2	0.005	0.018	1.2	0.07	0.11	2	0.2
MKD 4	0.014	0.038	2.5	0.11	0.15	3	0.2
MKD 10	0.04	0.08	5.0	0.16	0.20	3	0.2
MKD 18	0.07	0.14	9.0	0.23	0.28	6	0.2

- 1) Other torque ranges available on request.
- 2) Samarium Cobalt (SmCo) magnets available for higher temperature applications, up to 300° C.
- 3) Fully stainless steel model available.
- 4) Keyways according to standard DIN 6885 or American on request. Clearance of keyway, standard JS 9.
- 5) Larger radial misalignment possible.
- 6) Higher torque values available on request.